

**TEN YEAR ACIP
FOR
PADGHM FIELD**

CITY OF ALLEGAN, MI

**JULY, 2009
2060790
REVISED OCT., 2009**

2010 1. AVIGATION EASEMENTS

Several parcels in the Runway 11 approach had obstructions either to the approach surface or to the PAPI OCS at the completion of the runway extension and realignment project in 2008. Since there was not time to obtain avigation easements through the normal process, permission was obtained from property owners to do limited tree trimming. Many of these parcels are heavily wooded and will produce obstructions in the future as trees grow, so the Sponsor wishes to obtain avigation easements over up to eleven parcels in the Runway 11 approach.

New PAPIs were installed on both ends of Runway 11/29 in 2008. The OCS was cleared to AC requirements on both ends. FAA would not approve the PAPIs at flight check because there were obstructions outside the 20° cone of the OCS. The PAPIs were replaced with baffled units made by Siemens. FAA has now raised issues with obstructions to a line 10° from the PAPI locations (as opposed to 10° from runway centerline). If additional clearing is required, three additional avigation easements in the 29 approach and two additional easements in the 11 approach may be required. Also, one additional easement is needed in the 29 approach for existing trees on the north side of the approach just east of airport property.

2. SRE

The Sponsor wishes to purchase a snow removal truck. At present, the airport does not have any FAA funded snow removal equipment.

3. SRE Building

The Sponsor does not have space to store the proposed new SRE at the airport. A new 30' x 40' building will be constructed adjacent to the terminal apron for this purpose.

Cost Estimates

1. Avigation Easements	\$180,000
2. SRE	\$90,000
3. SRE Building	<u>\$60,000</u>
Total 2010	\$330,000
Federal	\$313,500
State	\$8,250
Local	\$8,250

2011 Obstruction Removal

Obstruction identified on avigation easements obtained in 2010 will be removed.

	Price	Item Amount	Quantity	Unit
Mobilization & General Conditions	1	Lsum	\$2,000	\$2,000
Safety & Security	1	Lsum	\$1,000	\$1,000
Tree Clearing/Topping	10	Acre	\$5,000	\$50,000
Restoration, Misc.	1	Lsum	\$2,000	<u>\$2,000</u>
		Total Construction		\$55,000
		Engineering		<u>\$10,000</u>
		Total		\$65,000
		Federal		\$61,750
		State		\$1,625
		Local		\$1,625

2012 T-Hangar

The Sponsor wishes to replace an existing 16-unit T-hangar building with a new 10 unit hangar building. The existing 16-unit hangar building is very old and in poor condition (see photos). The ALP has identified space adjacent to the newer T-Hangars for an additional building outside the BRL. The new hangars would have electric bi-fold doors, and space would be provided on one end for a larger aircraft

Cost Estimate

T-Hangar	\$300,000
Engineering	<u>\$40,000</u>
Total	\$340,000
Federal	\$323,000
State	\$8,500
Local	\$8,500

2014 ANIMAL CONTROL FENCING

Padgham Field is located adjacent to wooded areas along the south and east and a stream crosses just east of the main runway. Along with agricultural land to the east, this is prime habitat for deer which are regularly seen on the airport. The Sponsor wishes to construct a ten foot high fence around the perimeter of the airport to enhance safety. Security will also be improved by discouraging people from crossing the airport from residential areas to a recreation area south of the airport, and by providing gated access to hangars.

Cost Estimate

Item	Quantity	Unit	Price	Amount
Mobilization & General Conditions	1	Lsum	\$5,000	\$5,000
Safety & Security	1	Lsum	\$1,000	\$1,000
10' Chain Link Fence	15,000	Lft	\$18	\$270,000
Clearing, Gates, Misc.	1	Lsum	\$44,000	<u>\$44,000</u>

Total Construction	\$318,000
Engineering	<u>\$32,000</u>
Total	\$350,000
Federal	\$332,500
State	\$8,750
Local	\$8,750

2016 HANGAR SITE DEVELOPMENT

The ALP identifies an area east of 29th Street and north of the parallel taxiway to Runway 11/29 for hangar development. The Sponsor wishes to serve this area with municipal water and sewer service which can be extended across the airport from the terminal area. These improvements are needed to attract private hangar development which will improve airport revenue.

Cost Estimate

Item	Quantity	Unit	Price	Amount
Mobilization & General Conditions	1	Lsum	\$10,000	\$10,000
Safety & Security	1	Lsum	\$2,000	\$2,000
12" Water Main	2,000	Lft	\$40	\$80,000
8" Sanitary Sewer	2,000	Lft	\$40	<u>\$80,000</u>
Total Construction				\$172,000
Engineering				<u>\$18,000</u>
Total				\$190,000
Federal				\$180,500
State				\$4,750
Local				\$4,750

2017 NEW TERMINAL BUILDING

The current terminal building is part of the existing FBO hangar. It lacks adequate office space, pilot lounge area, pilot flight planning area and meeting space. The Sponsor wishes to construct a modern, efficient terminal building along the north side of the existing parking lot adjacent to M-222.

Cost Estimate

Terminal Building	\$265,000
Engineering/Architecture	<u>\$35,000</u>
Total	\$300,000

Federal	\$285,000
State	\$7,500
Local	\$7,500

2019 T-HANGARS

The Sponsor expects demand for hangar space will require additional units to be constructed by this time. Exact demand and configuration is unknown, so this item is just a space holder.

Cost Estimate

10 unit T-hangar Bldg. & site	\$300,000
Engineering	<u>\$40,000</u>
Total	\$340,000

Federal	\$323,000
State	\$8,500
Local	\$8,500

2020 TAXIWAY LIGHTS

Taxiways are currently marked by reflectors. If activity warrants, the Sponsor wishes to install medium intensity taxiway lights on all taxiways.

Cost Estimate

Item	Quantity	Unit	Price	Amount
Mobilization & General Conditions	1	Lsum	\$5,000	\$5,000
Safety & Security	1	Lsum	\$2,000	\$2,000
Cable & Trench	10,000	Lft	\$4	\$40,000
MITL	120	each	\$550	\$66,000
Vault Equipment	1	Lsum	\$10,000	\$10,000
Guidance Signs	10	each	\$2,500	<u>\$25,000</u>

Total Construction	\$148,000
Engineering	<u>\$22,000</u>
Total	\$170,000

Fed	\$161,500
State	\$4,250
Local	\$4,250

MICHIGAN STATE BLOCK GRANT PROGRAM
TEN-YEAR AIRPORT CAPITAL IMPROVEMENT PROGRAM (CIP) FY-2010* to FY-2020
*ACIP includes current development year (2010 already programmed - minor changes acceptable)

Airport Name: Padgham Field						Date prepared: 07/20/09, Revised 10/21/09					
Associated City: Allegan						Prepared By: James A. Cook, P.E., Prein&Newhof					
Sponsor: City of Allegan						Sponsor email address & phone: rhillard@cityofallegan.org 269-686-1113					
Airport Identifier: 35D						FINAL ACIP due to MDOT AERO: no later than 12/1/09					
Development Year	Project Description	Shown on ALP? (Yes or No)	ACIP Code**	NPIAS Priority Rating**	Federal Entitlements	Federal Apportionment	Federal Discretionary	State	Local	Total	Remarks/Item Justification - Provide as much detail as possible.
2010	1) Avigation Easements	yes	ST-LA-SZ	42	171,000			4,500	4,500	180,000	Approach protection.
2010	2) SRE		ST-EQ-SN	45	85,500			2,250	2,250	90,000	Airport does not have FAA funded SRE.
2010	3) SRE Building	no	ST-BD-SN	38	57,000			1,500	1,500	60,000	Airport does not have space to house new SRE.
2011	Obstruction Removal	yes	ST-OT-OB	46	61,750			1,625	1,625	65,000	Remove obstructions identified on easements obtained in 2010.
2012	T-Hangars	yes	ST-BD-MS	31	323,000			8,500	8,500	340,000	Replace aging hangars.
2013	Carry Over to 2014										
2014	Animal Control Fencing	no	ST-EQ-SE	40	332,500			8,750	8,750	350,000	Safety and security.
2015	Carry Over to 2016										
2016	Hangar Site Development	yes	ST-BD-MS	31	180,500			4,750	4,750	190,000	Attract private hangar development and enhance airport revenue.
2017	New Terminal Building	yes	CA-TE-CO	45	285,000			7,500	7,500	300,000	Insufficient space for office and pilot activities.
2018	Carry Over to 2019										
2019	T-Hangars	yes	ST-BD-MS	31	323,000			8,500	8,500	340,000	To satisfy anticipated demand.
2020	Light Taxiways	yes	ST-TW-LI	44	161,500			4,250	4,250	170,000	Improve visibility for night/low visibility operations.

**In accordance with FAA Order 5100.39A, Appendix 6 - Fields need to be completed

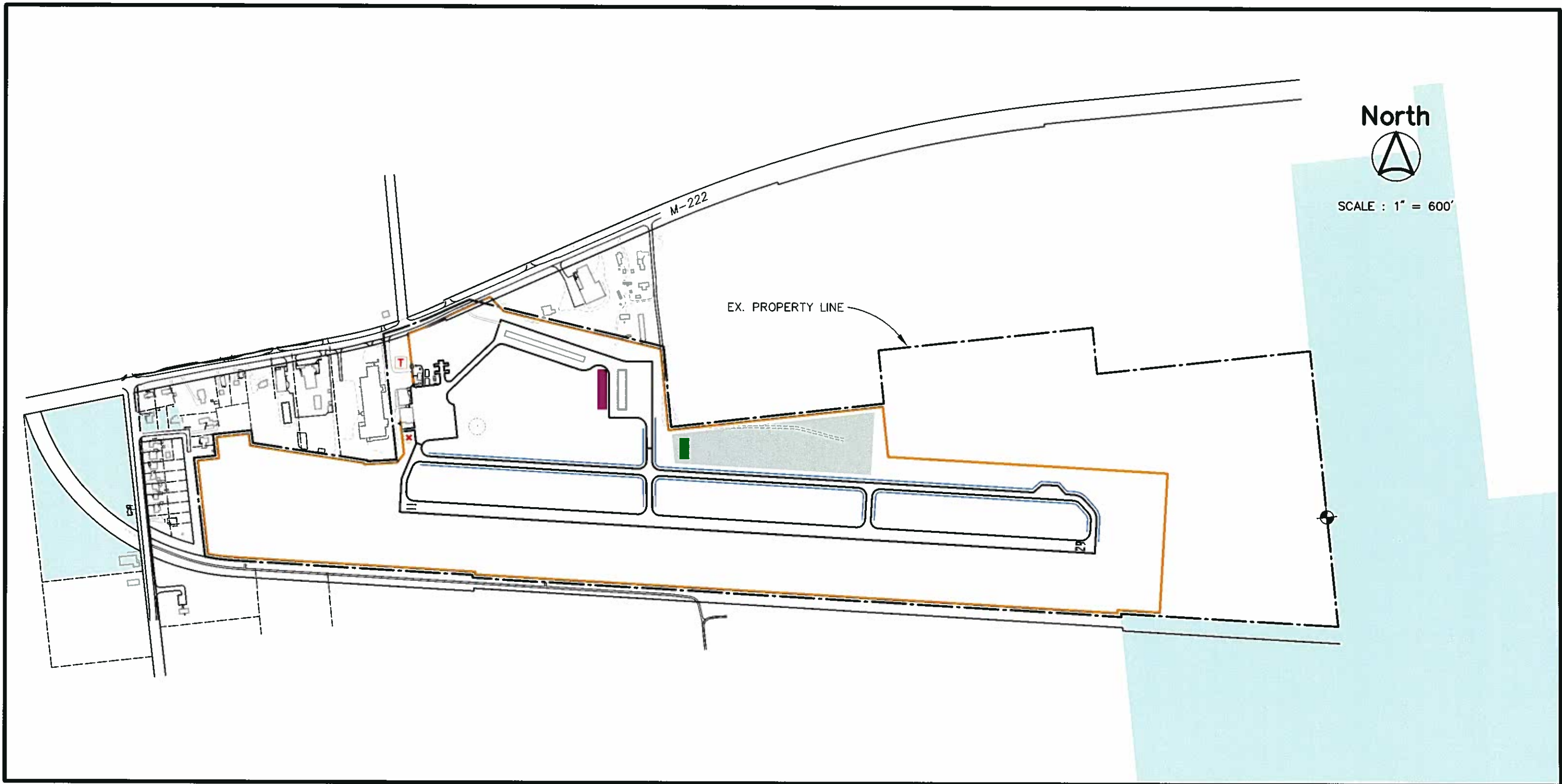









North

SCALE : 1" = 600'

EX. PROPERTY LINE

LEGEND

	2010 AVIGATION EASEMENT		2016 HANGER SITE DEVELOPMENT
	2010 SRE BUILDING		2017 TERMINAL BUILDING
	2012 T-HANGERS		2019 T-HANGERS
	2014 ANIMAL CONTROL FENCE		2020 TAXIWAY LIGHTS

PADGHAM FIELD
 ALLEGAN, MICHIGAN
 TEN-YEAR DEVELOPMENT PLAN
 SITE MAP

Prein&Newhof
 2090384
 OCTOBER, 2009